

**Kentucky Section - American Institute of Professional Geologists (KY-AIPG)
Presents a Professional Development Course**

“Review and Skills for Professional Geologist Exams”

SCHEDULE: Friday, September 12, 2014, check-in 8:00 a.m., class 8:30 a.m. – 4:30 p.m.

LOCATION: Kentucky Geological Survey
Well Sample and Core Library
2500 Research Park Drive
Lexington, Kentucky 40511

Detailed information on the course can be accessed at <http://ky.aipg.org/Announcements.htm>

DESCRIPTION: This course is intended to be one component of exam-preparation strategy for prospective exam-takers; it will not replace the long term effort of review but is designed to help candidates focus their preparations more efficiently. Topics to be covered include the design and intent of professional geology exams, and rapid-fire review of content-area topics such as structural geology, petrology, engineering geology, hydrology, and map/data interpretation, among others. Other review resources for the budget-minded exam-taker will also be presented.

Attendees will receive a certificate for eight (8) Professional Development Hours, a printed handout of the class review notes, and lunch with snacks and refreshments.

Name: _____

Employer: _____

Address: _____

City/State/Zip: _____

Telephone: () _____ Fax Number: () _____ Email: _____

**REGISTRATION: STANDARD - \$100, AIPG MEMBERS - \$75, GOVERNMENT EMPLOYEES - \$85,
STUDENTS - \$20, STUDENT AIPG MEMBERS - FREE**

After August 22, 2014: Standard Registration - \$125; AIPG Members - \$100, Government Employees - \$110

METHOD OF PAYMENT:

Company Check #: _____ Personal Check #: _____

Make checks payable to Kentucky Section - AIPG

MAIL TO: Kentucky Section - AIPG, P.O. Box 24690, Lexington, KY 40524
Phone: (859) 321-2171 E-Mail: billbrab@gmail.com

REFUNDS AND CANCELLATIONS:

All cancellations must be received in writing and sent to KY-AIPG, by mail or e-mail. Phone cancellations are not accepted. All cancellations postmarked by August 15, 2014 will receive a REFUND minus a 15 percent administrative fee. After August 22, 2014 registrants are no longer eligible for refunds; however, substitutions are

welcome. Call (859) 321-2171 for substitutions. **NO REFUND FOR REGISTRANTS WHO FAIL TO ATTEND.**

Disclaimer:

ASBOG does not endorse or support any review course or course preparation materials. The only official source of information for the ASBOG Professional Geology Exams can be found at the ASBOG website: (www.asbog.org). Potential exam takers are encouraged to carefully review the ASBOG Candidate Handbook.

The Kentucky Board of Registration for Professional Geologists cannot support or endorse any exam preparation materials or courses.

Attendance of the course does not guarantee success on the exams.

Course handouts are not designed as stand-alone study guides.

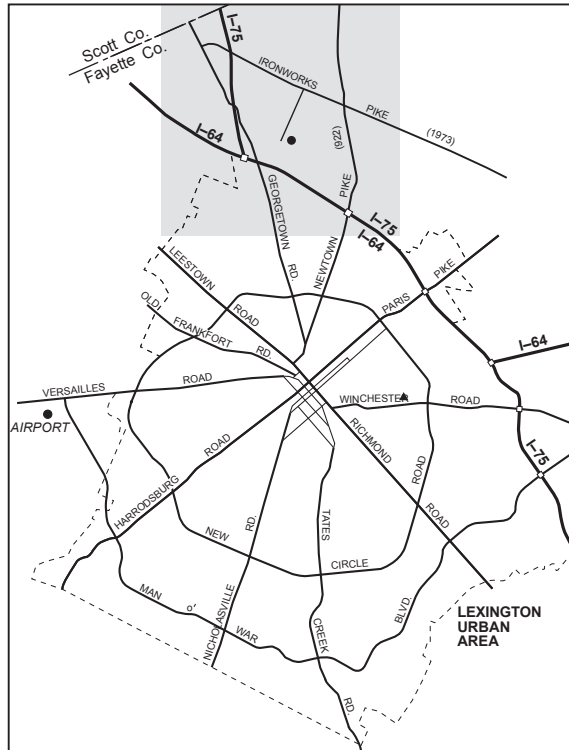
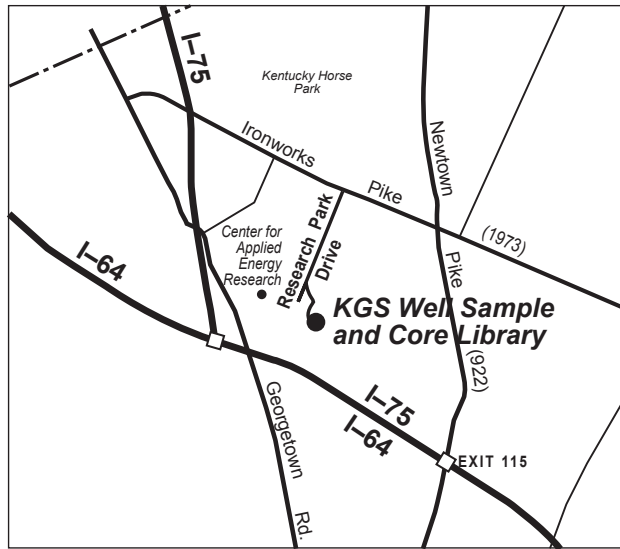

KGS Well Sample and Core Library location map.